

Connecting to internet using a option “H” WiFi card

This guide is designed to help with connecting a option “H” WiFi MegaTron XS / MT to the internet.

Getting Started:

Before going onsite, contact the Advantage Controls’ customer service department by calling **918-686-6211** or visit our website at http://www.advantagecontrols.com/downloads_other.php and get the latest firmware version for the MegaTron XS / MT. Update the controller firmware following our upgrade instructions. Also, follow the supplied User ID Setup Quick Steps if your Megatron is not already registered with WebAdvantage.

Note: Screens may vary slightly between models.

Step 1:

Press **Setup/Run**, **CONFIGURE**, **NETWORK**, **WIFI**.

(See figures 1, 2, 3 and 4.)

Step 2:

Use the UP/DOWN arrows to change USE WIFI FOR WEB to **ENABLE**. Press **Enter** to accept.

(See figure 5.)

Step 3:

Press **RESET** and then press **Enter** to accept. The communications card will reset after a short countdown.

(See figures 6 and 7.)

Step 4:

After the communications card has been reset cycle power to the controller.

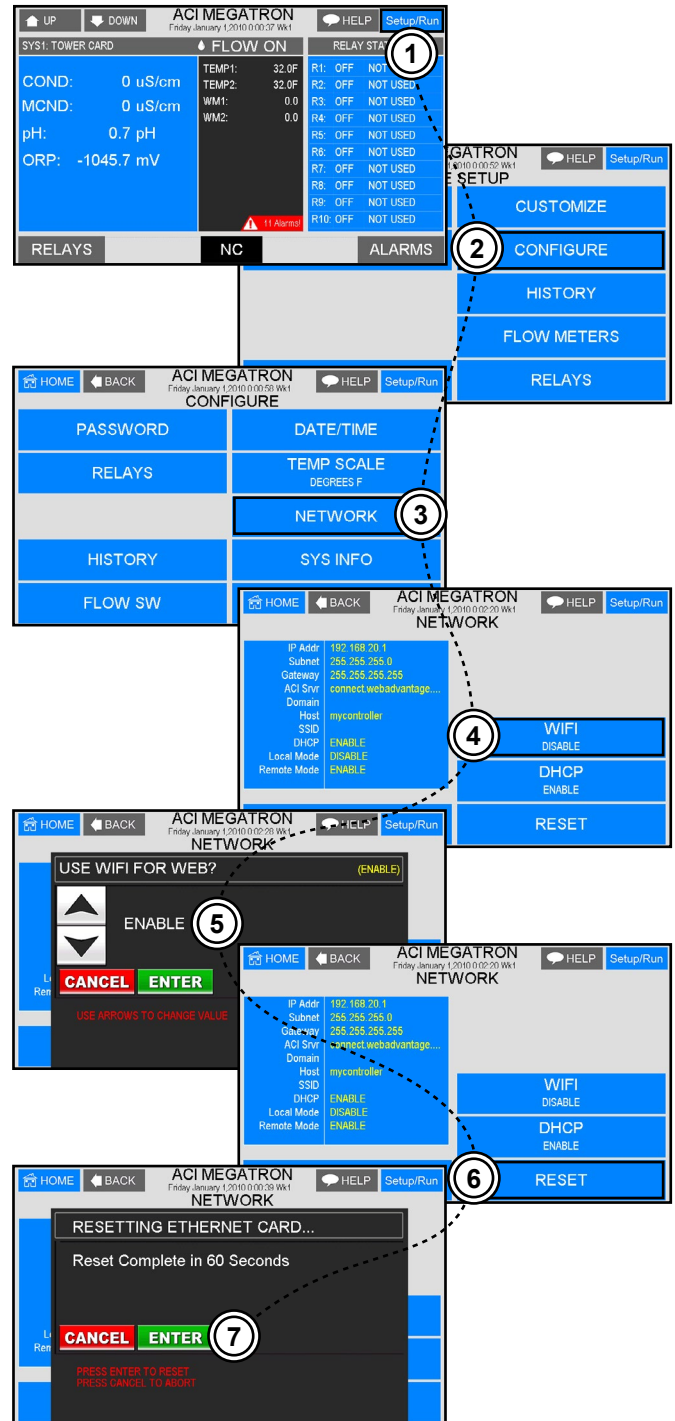

Connecting to internet using a option “H” WiFi card

Step 5:

After the controller reboots, press **Setup/Run**, **CONFIGURE**, **NETWORK**, **SETTINGS**, **WIFI NETWORK**.

(See figures 8, 9, 10, 11 and 12.)

Step 6:

Select your network and press **Enter** to accept.

(See figure 13.)

Step 7:

Enter your WiFi password then press **Enter** to connect.

Note: Blank passwords valid on some networks.

Step 8:

Press **Setup/Run**. When your controller is properly connected, a “ON WEB” message (MT models) or a “DR” message (XS models) will appear at the bottom/center of the Setup/Run screen.

(See figure 14.)

