

Flow Retainer Replacement Instructions

Instructions for New Style Flow Tee

Only use Flow Director with this style of tee

Instructions for Old Style Flow Tee

Only use this Nylon Washer with this style of tee

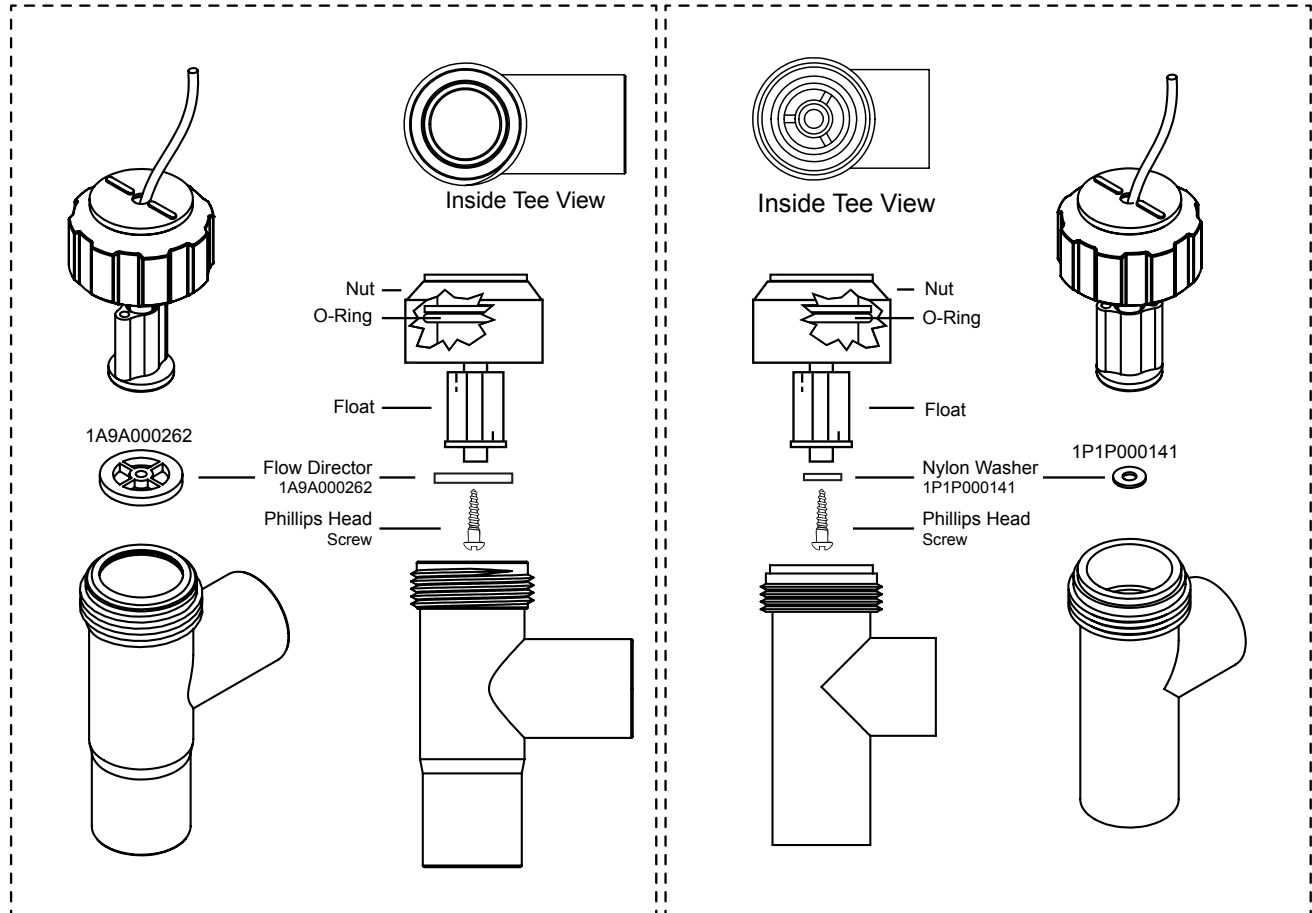

Notes:

1. The stainless steel screw that holds the washer or flow director onto the flow stem is item 1P1P000169.
2. The O-ring (E-30-PH) sits on the lip surface of the tee.
3. Do not use the nylon washer (1P1P000141) with the flow director (1A9A00262) on the new style tee.